

- **Material Designation:** YW20 series waterproof connector



- **Materials Processes, Surface Treatment**

- **Contact**

Materials: Male Pin: Brass; Female Pin: Phosphor Bronze

Processes: Machining

Surface Treatment: Gold Plating for 4u" over nickel

- **Shell**

Materials: Zinc alloy

Processers: die-cast

Surface Treatment: Nickel

- **Insulator**

Materials :PBT

Processes: Injection

Color: Black

- **Material Introduction:**

- **Basic Information**

The performance of this connector is in conformity with Linko electric enterprise standard(in accordance with the TIA/EIA 568, MIL, IEC, CNS, etc.). ALL zinc ally shell, it has good capacity of resisting electromagnetic disturbance, screw-threaded coupling, The socket is mounted on the panel through the square flange, quick and easy nut locking system design. the contact part shall be welded with the end of the conductor.

Offer standard insert arrangements from 2-12 pins.

- **Packing and Storage:**

The production are packed in plastic bag, The packing list must be set in every carton, which has been given clear information of material designation, part number, production order number, packet quantity and total product quantity. The packaged production should be stored in the

storeroom , in which Environment Temperature is $-40^{\circ}\text{C} \sim +80^{\circ}\text{C}$,Relative humidity $\leq 85\%$,no acidic, alkaline and other corrosive gases.

■ **Mating Type.**

Mated with: YW20 connector (male)

■ **Applicable Standards :** Meeting TIA/EIA 568、MIL、IEC、CNS Standards

■ **Process Requirements**

◆ **According to form of terminal**

The form of terminal is welding, the welding must be firm and cannot have pseudo soldering

◆ **According to form of mounting**

Please see the mounting hole figure.

PRODUCT CODE

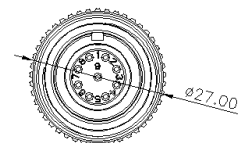
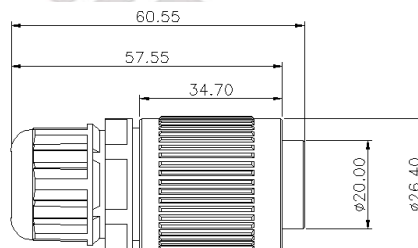
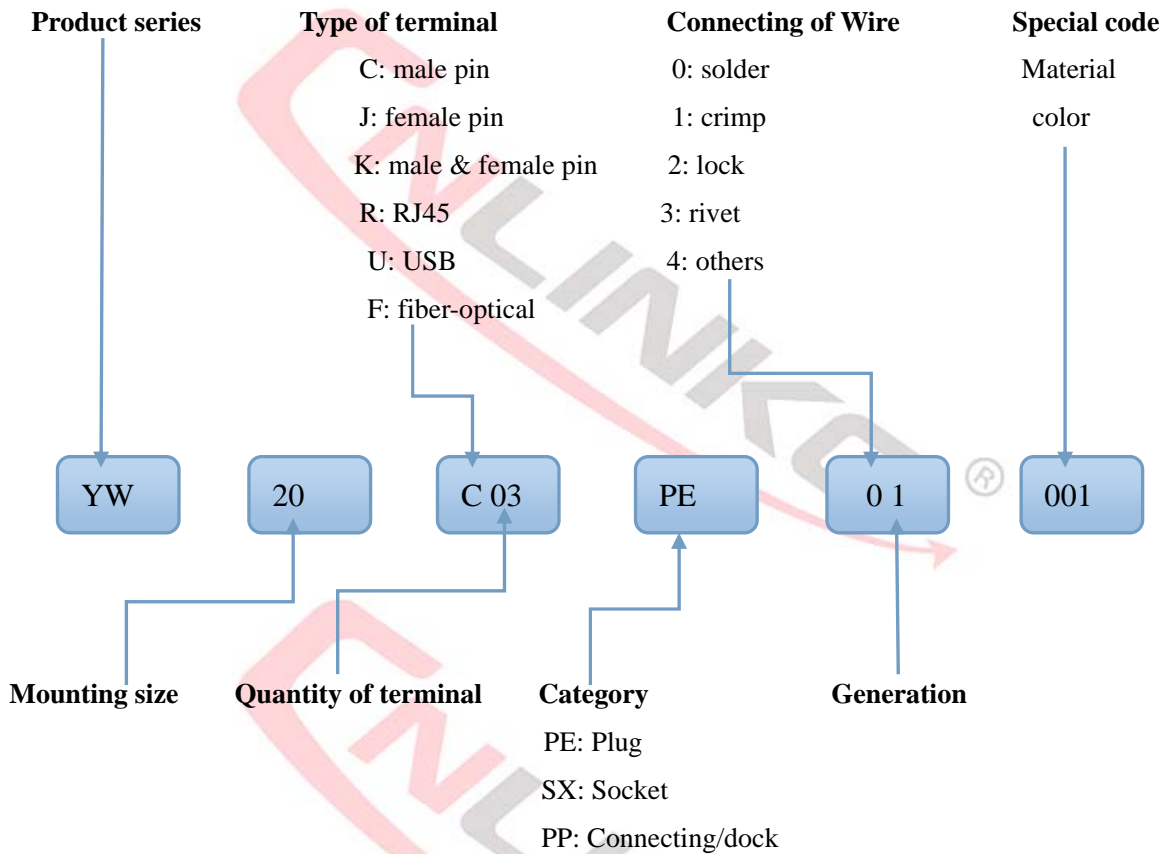

YW-20-C ___ PE-XX-001 Plug

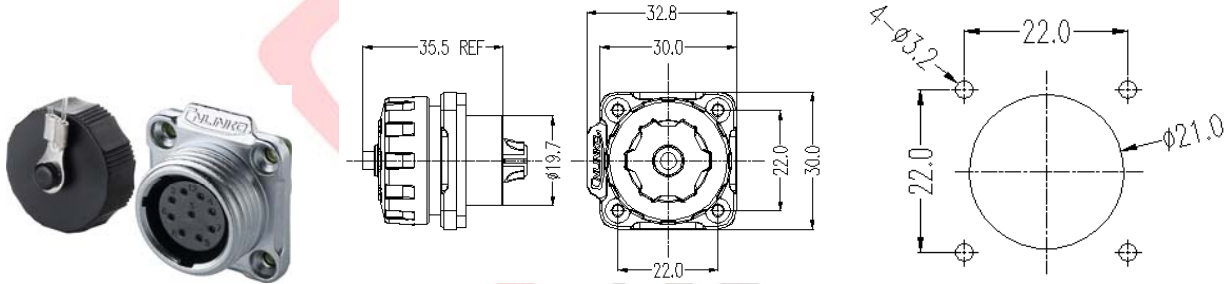

YW-20-C__SX-XX-001

Four holes socket

Mounting hole

● Product Characteristics Form

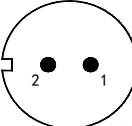
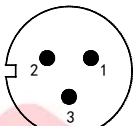
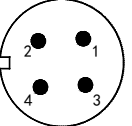
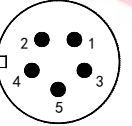
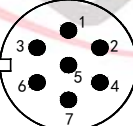
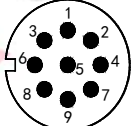
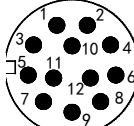
Number of pins	 Two pins	 Three pins	 Four pins	 Five pins	 Seven pins	 Nine pins	 Twelve pins
Rated current	20A	20A	20	12A	12A	5A	5A
Operating voltage	500V	500V	500V	400V	400V	250V	250V
Withstanding voltage	2500V	2500V	2500V	2000V	2000V	1500V	1500V
Contact resistance	<1mΩ	<1mΩ	<1mΩ	<2.5mΩ	<2.5mΩ	<5.0mΩ	<5.0mΩ
Temperature rise	20A 30℃ ↓ ;25A 40℃ ↓ ;30A 50℃ ↓			12A 30℃ ↓ ;15A 40℃ ↓ ;20A 50℃ ↓			
Contact dimension	Φ2.7*2	Φ2.7*3	Φ2.7*4	Φ1.8*5	Φ1.8*7	Φ1.0*9	Φ1.0*12
Insertion and extraction force	4.0N Max.	6.0N Max.	8.0N Max.	6N Max.	8.2N Max.	2.7N Max.	3.6N Max.
Mating cycle	1700 Times						
Screw torque	42-53 (N.m) Torque wrench 200 (N.m)						
Temperature and humidity	-40℃ ~ +80℃ ;40℃, 85%RH.						
Vibration	Frequency:5~200Hz, Amplitude:5mm, Speed :10m/s, No instantaneous short circuit in 0.10us.						
Impact resistance	294m/s ²						
Salt spray	PH6.5-7.2, NaCl, 5% 48H						
Wire specification (power)							

Wire specification (signal)							
Applicable wire diameter	Scope of application(OD: Φ1-Φ11.5) mm . With waterproof ring (Φ12mm 、Φ6.5mm)						
Protection level	IP67						
Certification standard	Comply with the TUV and UL certification standards						
Operation tool	Design with national standard opening wrench (see attached table)						

