

motoRobit.com

Parameter description **X**



Metal

power switch button

Parameter Description

Electrical parameters

switching voltage:	1.5V-250VAC/DC
switch current:	3mA~3A
Contact resistance value:	≤50mΩ
Insulation resistance:	≥1000mΩ
Compressive strength:	1900VACmin

Other Ratings

switch gear:	2 gears 3 gears
Insulation Resistance:	Forms of work
Nut torque:	5~14N.m
key pressure:	About 2.5~3N
Connection method:	Solder terminal (pin)
Nominal Operating Force:	Approx.: 1.5N
Contact Type:	1NO1NC/2NO2NC

Materials & Finishes

Base:	Pa66
Active rod:	PA66
Compression spring:	SUS304
Wire:	20AWG

Environmental Data

Operating Temperature Range:	-30°C through +85°C
Humidity:	90~95% humidity for 240 hours @ 40°C
Vibration:	10~55Hz with peak-to-peak amplitude of 1.5mm traversing the frequency range & returning in 1 minute; 3 right angled directions for 2 hours
Sealing:	Ip66

Installation

Installation aperture:	19/22mm
Soldering Time & Temperature:	The welding time is 3 seconds and the welding temperature is not higher than 280 °C



Standard model illustration example Switch configuration and accessories

PA66 flame retardant material

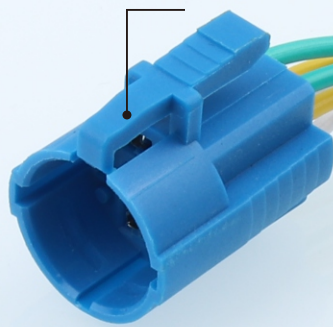

20AWG wire

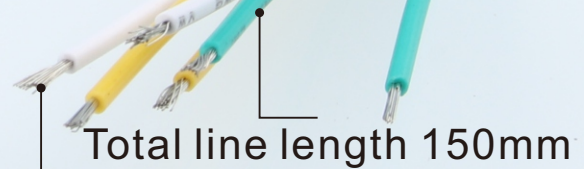

Total line length 150mm

Stripping length 3~5mm

Size and material application

22X

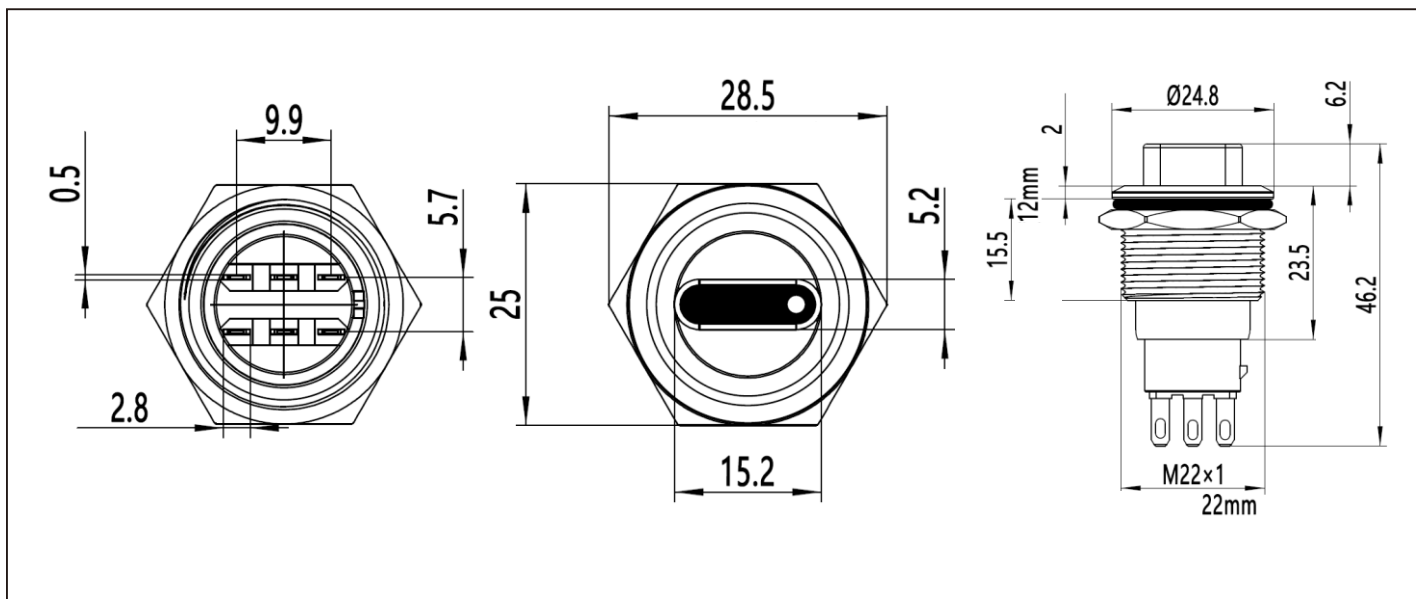

19X

