

16H series metal buttons

Button switch features

Working form: reset type; Appearance material: nickel-plated copper, 304 stainless steel, aluminum alloy oxide black options;
TNO function/silver contacts/silver-plated feet;
metal appearance design is more suitable for improving the appearance of equipment and attracting users' attention;
The button supports a maximum load current of 3A, and a voltage of 1.5V~250V AC and DC;
IP66 waterproof; mechanical life can reach 200,000 times.



WD16H series metal push button switch

A variety of appearance styles to choose from



Spherical

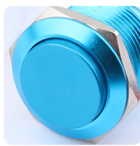

High head money

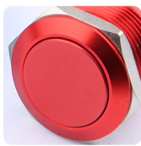

Flat head

Product parameters

Switching voltage	1.5V-250VAC/DC
Forms of work	self-repair
Protection class	IK10
Waterproof level	IP65
Contact resistance	≤50mΩ
Switch current	3A
Working environment	-30°C ~ +80°C
Switch combination	1NO
Mechanical life	20W次
Mounting Aperture	16mm

Product Size

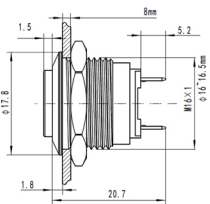
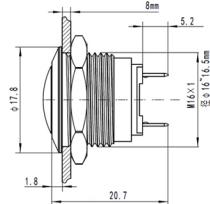
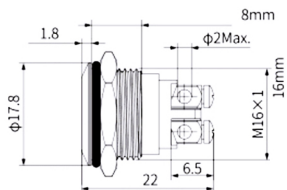
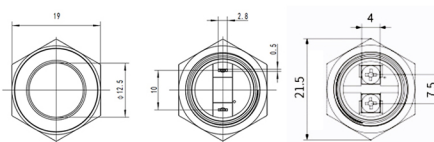

Pin analysis



Company Profile

Wandu Electric Co., Ltd. is a modern enterprise focusing on the field of industrial control electricals, integrating research and development, intelligent manufacturing, sales and service.
The company mainly produces various series of metal button switches, signal indicating switches, and indicators. The products have passed various comprehensive tests and inspections, fully embody the smart manufacturing process, and have obtained a number of national patents, as well as CCC, CCC, CE, RoHS and other authority Certified. Products are widely used in household appliances, machinery manufacturing, biological manufacturing, precision machinery testing, medical, automotive, marine, aviation, military equipment and many other fields.
The company always adheres to the "quality as the core, innovation and development" to continuously improve the quality assurance system and service system in order to provide customers with better quality industrial control solutions, thereby creating sustainable value. It is willing to go hand in hand with customers at home and abroad to grow and achieve together!



Certification authority

Honor is a recognition, with the wisdom and sweat of all Wandu people hidden behind it.
The company has been "taking quality as the core and innovation for development".
We will continue to innovate, improve the quality assurance system, and continue to forge ahead with customer recognition of us as our highest honor.



Material can be selected as required

Aluminum oxidation: It can oxidize color, not easy to oxidize and rust.
Nickel-plated copper: high hardness, strong adhesion and wear resistance.





未经万度电气书面允许，严禁打印和复印

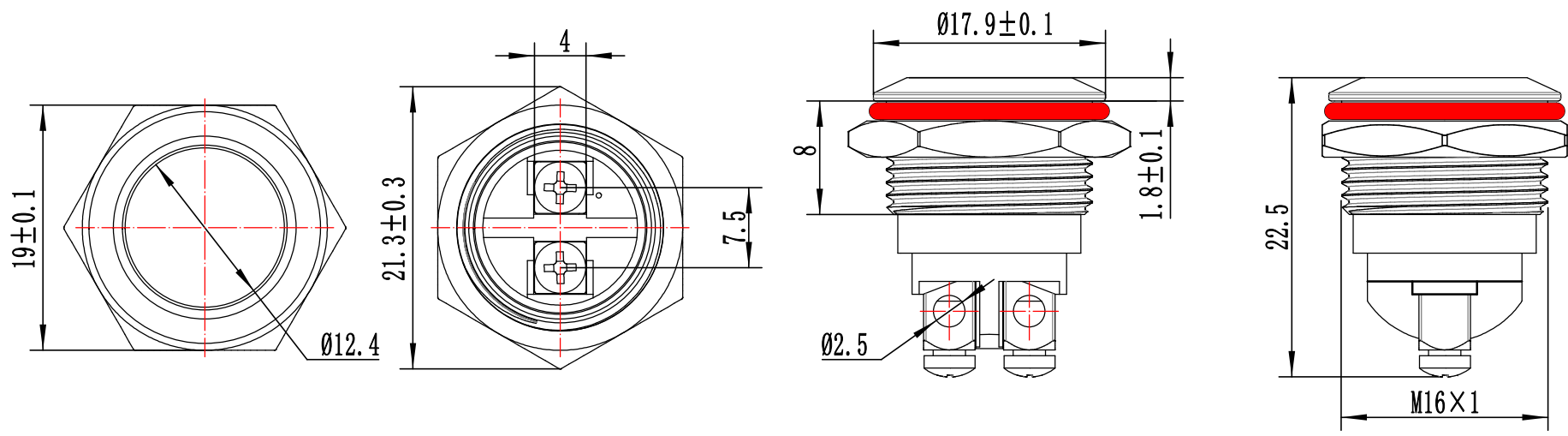

Mounting hole diameter 安装孔直径	16~16.2mm	Switch combinations 开关组合	1NO (一常开)	Housing material 外壳材质	SUS304/Brass nickel-plated/aluminum alloy anodized SUS304/黄铜镀镍/铝合金阳极氧化
Switching voltage 开关电压	1.5V~250VAC/DC	Lamp bead voltage 灯珠电压	/	Key Material 按键材质	PC&SUS316 聚碳&不锈钢SUS316
Current rating: 额定电流:	Resistive loads 阻性负载	DC-13:12V/24V 3A AC-15:110V/250V 5A	Lamp bead current 灯珠电流	Contact material 触点材质	H65 silver plating H65镀银
	Inductive loads 感性负载	AC-15:110V/250V 0.75A DC-13:110V 0.75A	PIN pin style PIN脚样式	Electrical life 电气寿命	DC-13:12V/24V 1.5A >100,000 times AC-15:110V/220V 3A >10万次
Rated heating current 额定发热电流	ith: 5A/250VAC	Base material 基座材质	Modified nylon PA66 改性尼龙PA66	Contact resistance 接触阻值	Contact resistance ≤50mΩ
Waterproof rating 防水等级	IP66 at the end of the button 按键端IP66	Dielectric strength 绝缘强度	≥100MΩ 500VDC /h	Press down on pressure 按键下压力	Approximately 2.5~4N 约2.5~4N
Ambient temperature 环境温度	-30℃~85℃	Compressive strength 耐压强度	Pins and housings 1500VAC 20mA/min 引脚与外壳 1500VAC 20mA/min	Button travel 按键行程	The key stroke is 2.5mm and the contact stroke is 1mm 按键行程2.5mm 接触行程1mm
Form of work 工作形式	Self-locking 自复式	Glowing color 发光颜色	/		

Initial state 初始状态	
Explanation of switch working status 开关工作状态说明	
Button - Press down 按键-按下	Button - Eject 按键-弹出
POWER ON 接通	Power OFF 断开

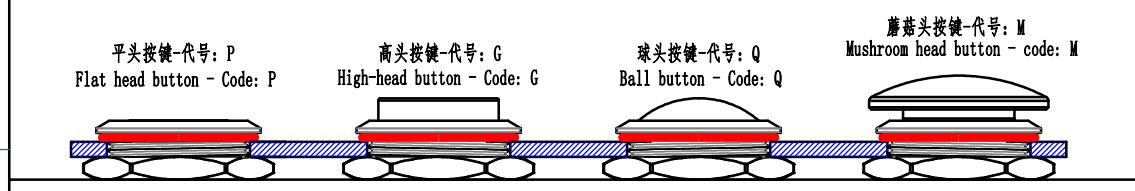

定制字符-代号: T
Custom character - Codename: T

This model switch can be customized with any character, but it does not have the character light function!
本型号开关可定制任意字符,但不带字符发光功能!

3D View: 三维视图:	Schematic Diagram: 电气原理:	Cut-out size: 开孔尺寸:	PART NAME: 零件名称:	MATERIAL: 材料:	DRAWN: 绘图:	WEIGHT(g): 重量:
			WD16H Lamless Screw End Series Datasheet WD16H无灯螺丝端系列规格书	/	彭翔翔 日期 2024.03.14	10
			PART No.: 零件编号:	SCALE: 比例:	CHECK: 审核:	UNIT: 单位:
			WD16H-P0-GGS01	2:1	彭翔翔 日期 2024.03.14	mm
			 浙江万度电气有限公司 Zhejiang Wandu Electric Co., Ltd	SHEET: 页数:	APPROVAL: 批准:	SIZE: 图幅:
				2 OF 1 第 1 页 共 2 页	彭翔翔 日期 2024.03.14	A4
			PART No.: 料号:	VERISON: 版本:		PROJECTION: 投影:
			/	V0.0		

Panel opening size
面板开孔尺寸

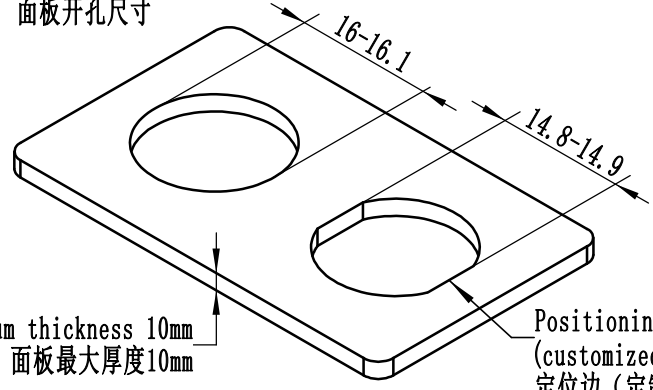

Installation method diagram
安装方法示意图

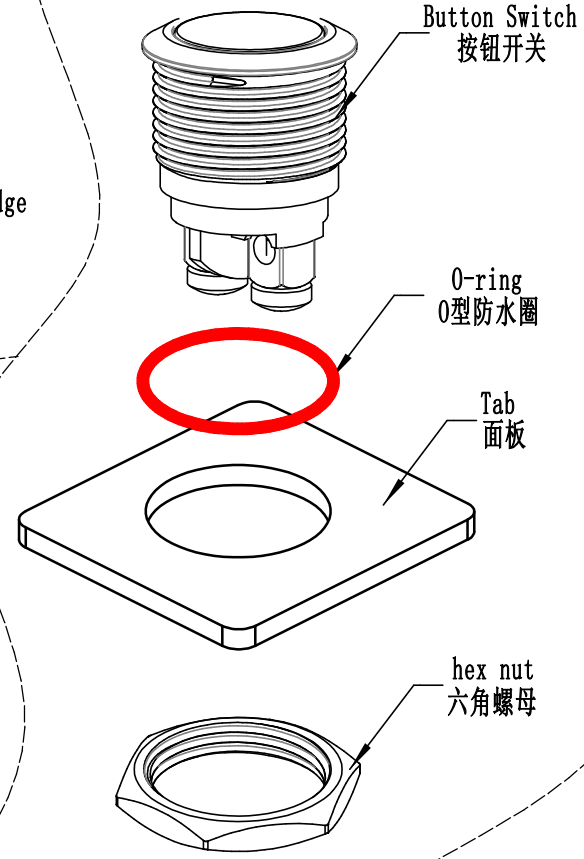

Attachment: 0-shaped silicone waterproof ring
附件: 0型硅胶防水圈

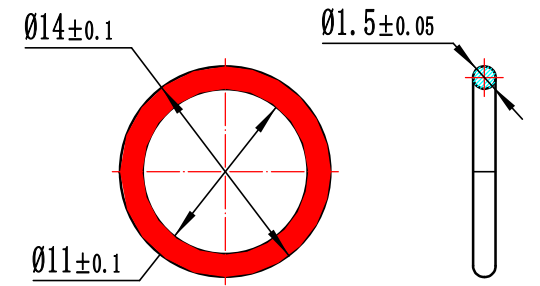

Attachment: Hexagonal Nut
附件: 六角螺母

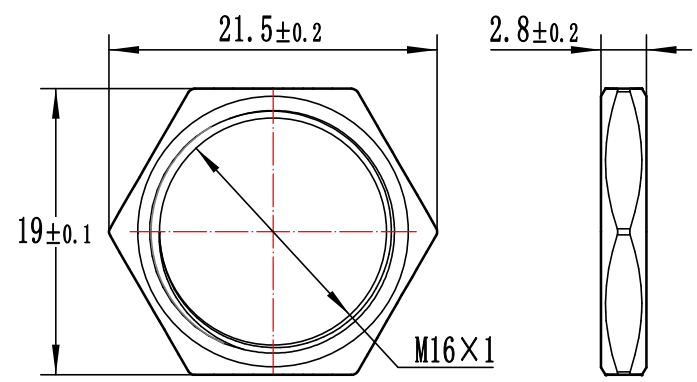
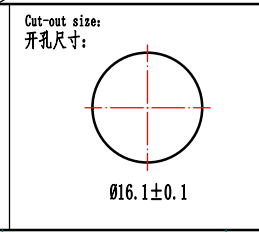
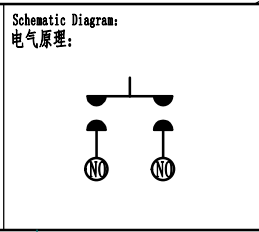
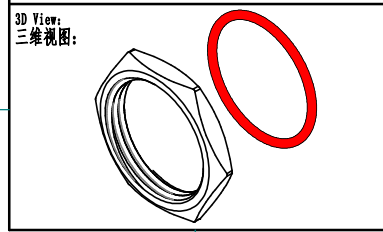
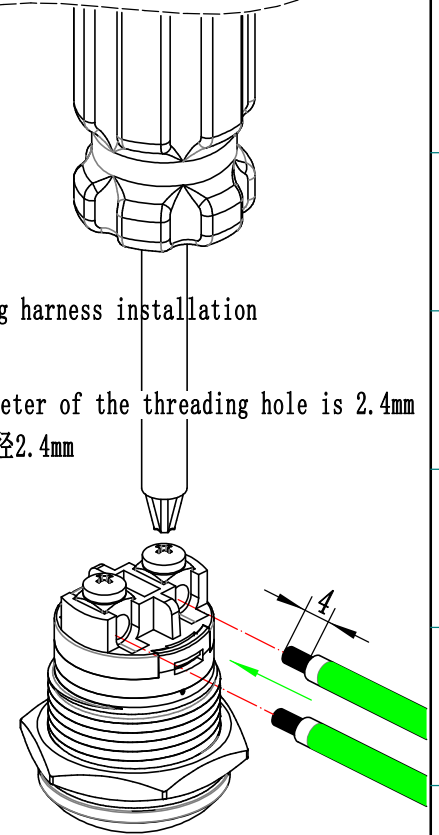

Diagram of wiring harness installation
线束安装图示

The maximum diameter of the threading hole is 2.4mm
穿线孔最大通过直径2.4mm



PART NAME: 零件名称:	WD16H Lampless Screw End Series Datasheet WD16H无灯螺丝端系列规格书
PART No.:	WD16H-P0-GGS01
浙江万度电气有限公司 Zhejiang Wandu Electric Co., Ltd	

MATERIAL: 材料:	/
SCALE: 比例:	2:1
SHEET: 页数:	2 OF 2 第 2 页 共 2 页
PART No.:	/

DRAWN: 绘图:	彭翔翔 日期 2024.03.14
CHECK: 审核:	彭翔翔 日期 2024.03.14
APPROVAL: 批准:	彭翔翔 日期 2024.03.14
VERISON: 版本:	V0.0

WEIGHT(g): 重量:	10
UNIT: 单位:	mm
SIZE: 图幅:	A4
PROJECTION: 投影:	



未经万度电气书面允许，严禁打印和复印

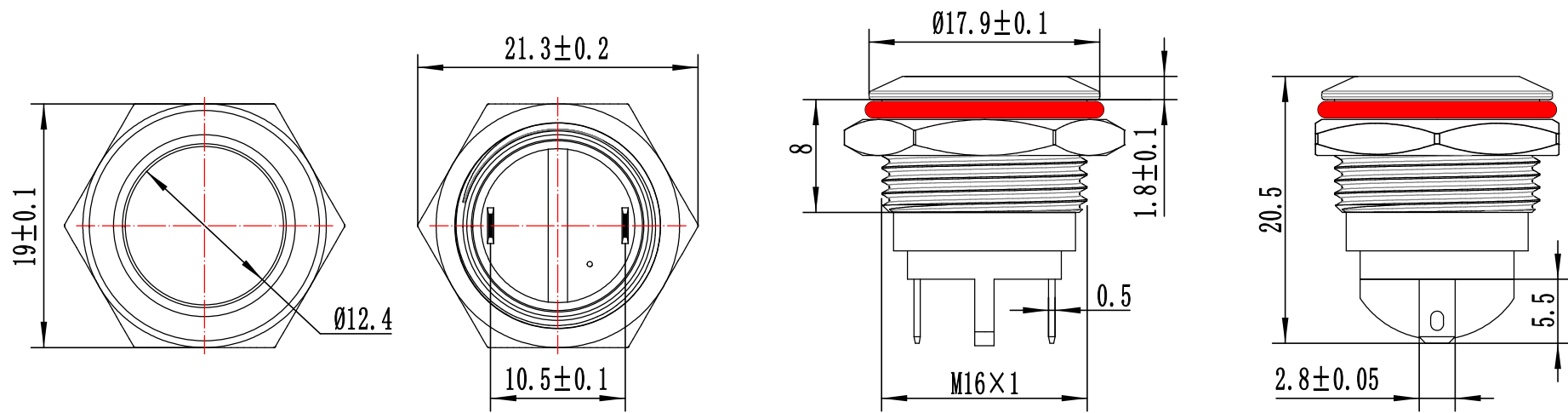

Mounting hole diameter 安装孔直径	16~16.2mm	Switch combinations 开关组合	1NO (一常开)	Housing material 外壳材质	SUS304/Brass nickel-plated/aluminum alloy anodized SUS304/黄铜镀镍/铝合金阳极氧化
Switching voltage 开关电压	1.5V~250VAC/DC	Lamp bead voltage 灯珠电压	/	Key Material 按键材质	PC&SUS316 聚碳&不锈钢SUS316
Current rating: 额定电流:	Resistive loads 阻性负载	DC-13:12V/24V 3A AC-15:110V/250V 5A	Lamp bead current 灯珠电流	Contact material 触点材质	H65 silver plating H65镀银
	Inductive loads 感性负载	AC-15:110V/250V 0.75A DC-13:110V 0.75A	PIN pin style PIN脚样式	Electrical life 电气寿命	DC-13:12V/24V 1.5A >100,000 times AC-15:110V/220V 3A >10万次
Rated heating current 额定发热电流	ith: 5A/250VAC	Base material 基座材质	Modified nylon PA66 改性尼龙PA66	Contact resistance 接触阻值	≤50mΩ
Waterproof rating 防水等级	IP66 at the end of the button 按键端IP66	Dielectric strength 绝缘强度	≥100MΩ 500VDC /h	Press down on pressure 按键下压力	Approximately 2.5~4N 约2.5~4N
Ambient temperature 环境温度	-30℃~85℃	Compressive strength 耐压强度	Pins and housings 1500VAC 20mA/min 引脚与外壳 1500VAC 20mA/min	Button travel 按键行程	The key stroke is 2.5mm and the contact stroke is 1mm 按键行程2.5mm 接触行程1mm
Form of work 工作形式	Self-locking 自复式	Glowing color 发光颜色	/		

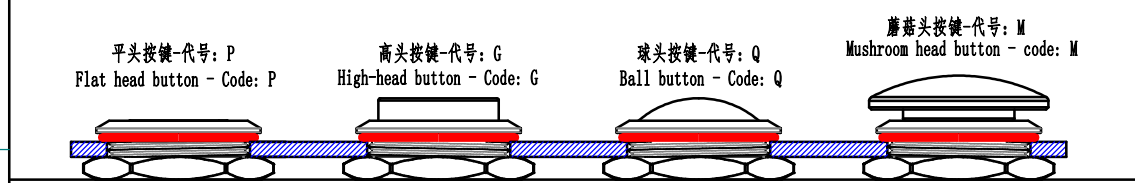
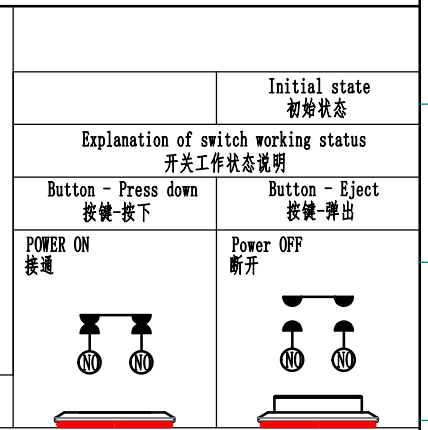

定制字符-代号: T
Custom character - Codename: T

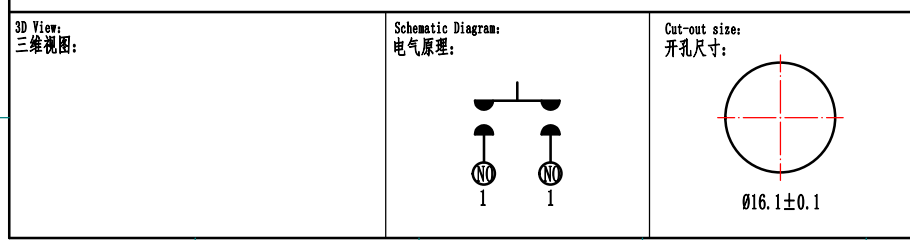

PART NAME: 零件名称:	WD16H Lampless Series Datasheet WD16H无灯系列规格书	MATERIAL: 材料:	/	DRAWN: 绘图:	彭翔翔 日期 2024.03.14	WEIGHT(g): 重量:	10
PART No.:	WD16H-P1-GGS01	SCALE:	2:1	CHECK: 审核:	彭翔翔 日期 2024.03.14	UNIT: 单位:	mm
浙江万度电气有限公司 Zhejiang Wandu Electric Co., Ltd		SHEET: 页数:	2 OF 1 第 1 页 共 2 页	APPROVAL: 批准:	彭翔翔 日期 2024.03.14	SIZE: 图幅:	A4
		PART No.:	/	VERSION: 版本:	V0.0	PROJECTION:	

Panel opening size
面板开孔尺寸

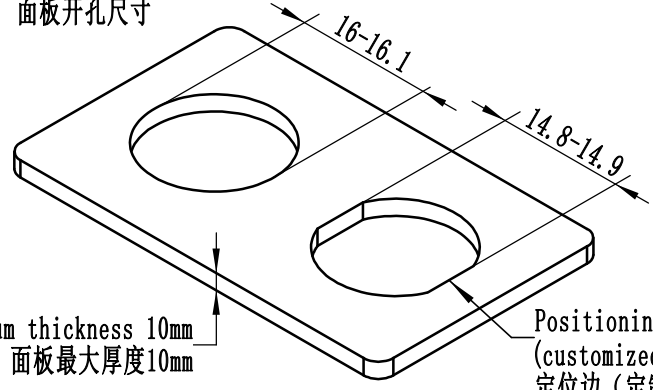

Maximum thickness 10mm
面板最大厚度10mm

Positioning edge
(customized)
定位边 (定制)

Installation method diagram
安装方法示意图

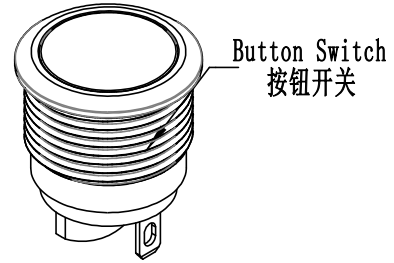

Button Switch
按钮开关

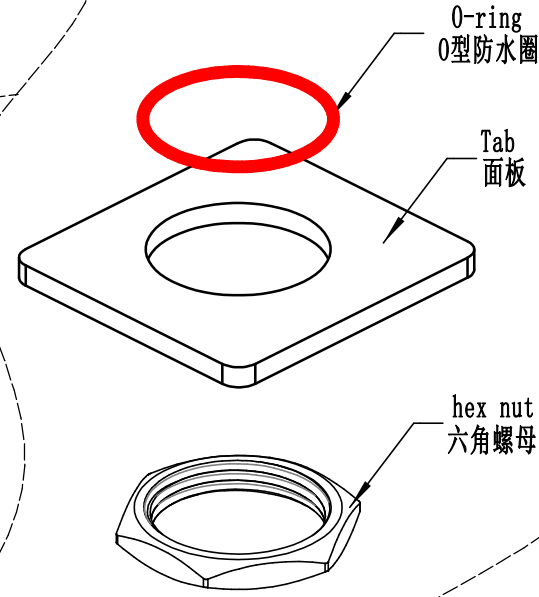

O-ring
O型防水圈

Tab
面板

hex nut
六角螺母

Attachment: O-shaped silicone waterproof ring
附件: O型硅胶防水圈

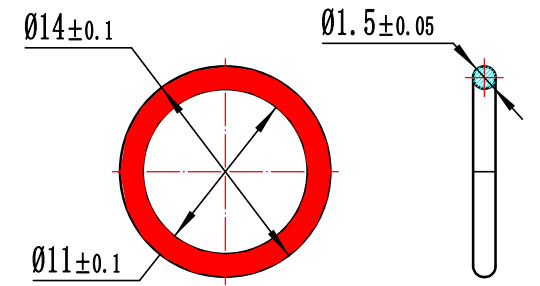

焊接需注意，烙铁温度不得超过280℃
焊接时间不能超过3秒，以免损坏开关本体。
Soldering should be noted that the temperature of the soldering iron should not exceed 280° C, and the soldering time should not exceed 3 seconds, so as not to damage the switch body.

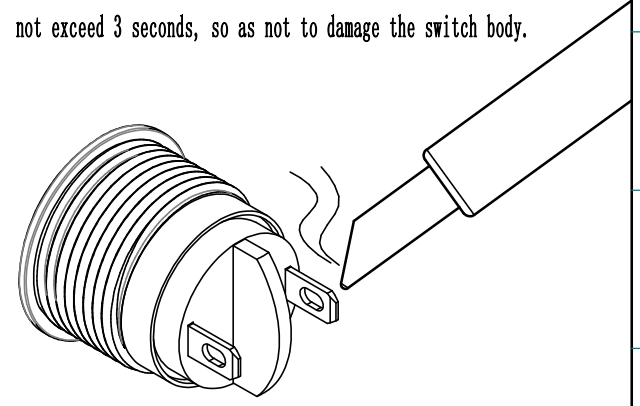

焊接时请做好防护，避免烫伤!
Please take good precautions when welding to avoid burns!

Attachment: Hexagonal Nut
附件: 六角螺母

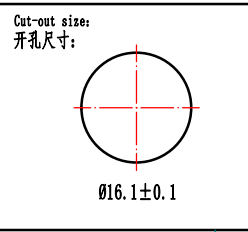
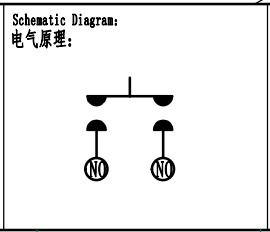
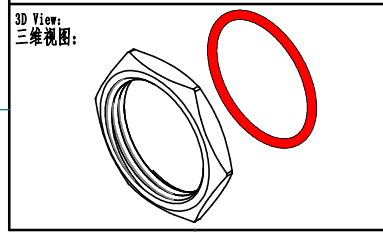
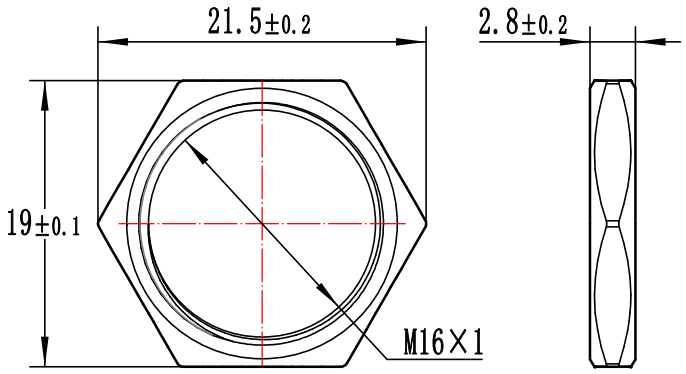

PART NAME: 零件名称:	WD16H Lamplless Series Datasheet WD16H无灯系列按钮开关规格书
PART No. : 零件编号:	WD16H-P1-GGS01
浙江万度电气有限公司 Zhejiang Wandu Electric Co., Ltd	

MATERIAL: 材料:	/
SCALE: 比例:	2:1
SHEET: 页数:	2 OF 2 第 2 页 共 2 页
PART No. : 料号:	/

DRAWN: 绘图:	彭翔翔 日期 2024.03.14
CHECK: 审核:	彭翔翔 日期 2024.03.14
APPROVAL: 批准:	彭翔翔 日期 2024.03.14
VERISON: 版本:	V0.0

WEIGHT(g): 重量:	10
UNIT: 单位:	mm
SIZE: 图幅:	A4
PROJECTION: 投影:	