

Dimension:
Unit=mm

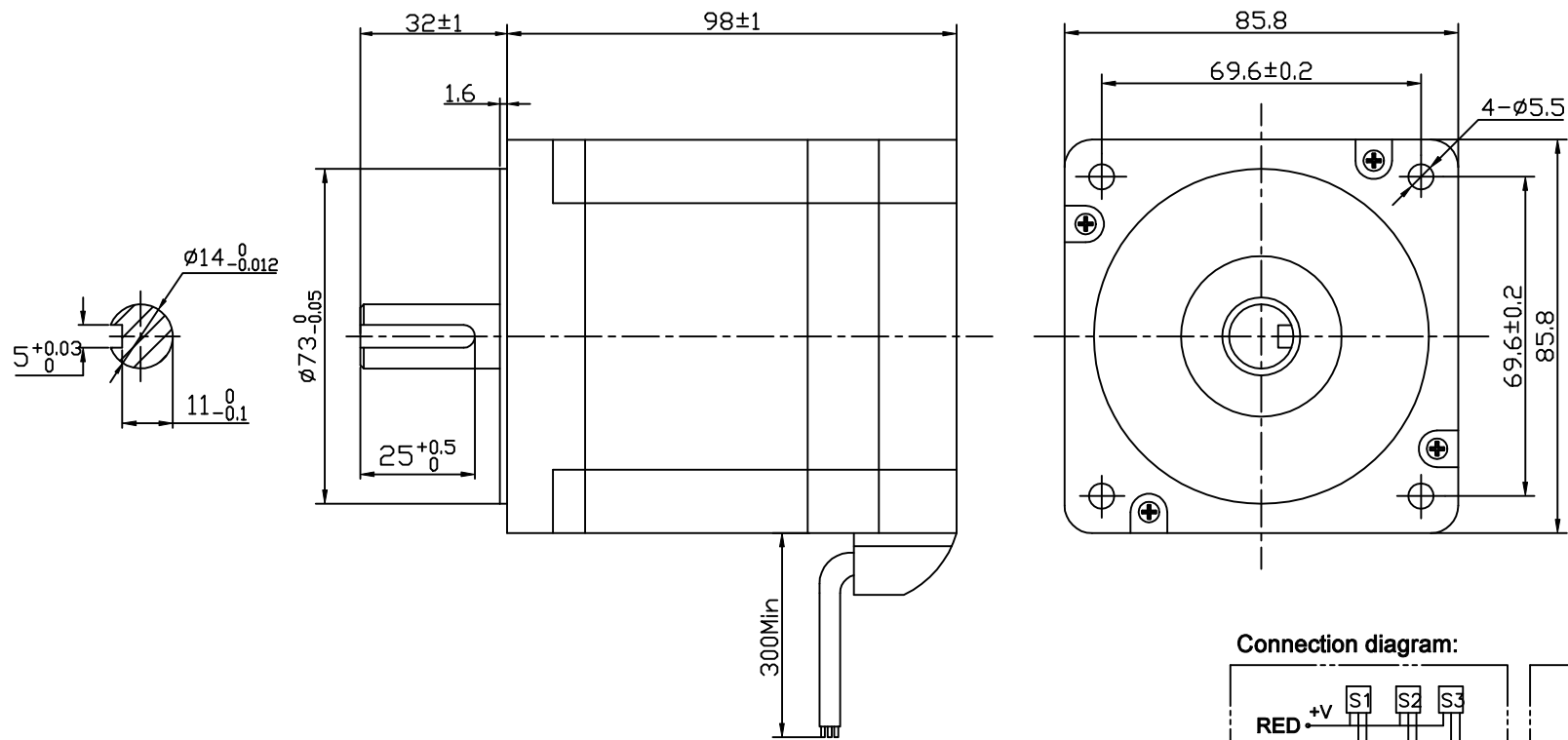

ROTATION: CW SEE FROM LEAD END

MANUFACTURER MODEL	JK86BLS84-X004
NUMBER OF POLES	8 POLES
PHASE TO PHASE RESISTANCE	0.25 OHMS
NOMINAL VOLTAGE	48 VDC
NO LOAD SPEED	3700±10% RPM
NO LOAD CURRENT	2 Amps Max.
RATED TORQUE	1.05 N-m
RATED SPEED	3000±10% RPM
OUTPUT POWER	330 W
BACK EMF CONSTANT	12.9 V/kRPM
TORQUE CONSTANT	0.12 N-m/A
INSULATION CLASS	B

ELECTRICAL CONNECTION TABLE		
+5V	RED	红
HALL U	YEL	黄
HALL V	GRE	绿
HALL W	BLU	蓝
GND	GND	黑
PHASE U	YEL	黄
PHASE V	GRE	绿
PHASE W	BLU	蓝

Connection diagram:

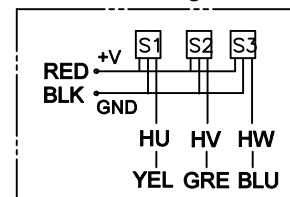

Hall sensor cable
Note: hall sensor power supply
voltage +5 to +20VDC

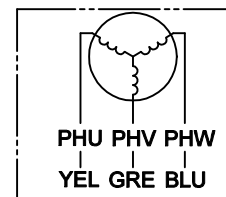

Wiring cable

REV.	QTY.	No.	SIG.	DATE	Title: Specification	常州精控电机电器有限公司
DESIGN	CCY	19.01.09	STD.			
CHECK					CLS.MAK	WEIGHT
PROC.			APPR.		SCALE	
PAGE: 1/1					JK86BLS84-X004	
					www.jkongmotor.com	