

DP-2FM 一体式计量水泵 / DP-2FM Flowmeter integrated pump



PRODUCT INFORMATION/ 产品信息

Pump Design/产品名称: Diaphragm Water Pump/隔膜水泵
 Insulation/绝缘等级: Class A
 Net Weight/产品净重: 0.070Kg
 Outlet Connector/出水接口: Barb port/倒扣 (OD4.8mm/6.5mm)

LABORATORY TEST CONDITION/ 工作条件

- Ta within 60°C, Tf within 35°C / Ta: 60°C以下, Tf: 35°C以下
- ED 100% or work as specified /连续工作或按指定工作方式
- Ta: Ambient temperature/Ta: 环境温度
- Tf: Temperature of fluid water/Tf: 流体温度

APPLICATIONS/ 应用领域

American Coffee Machine、Capsule Coffee Machine、
 Beverage Dispenser、Drinking Water Dispenser
 美式咖啡机、胶囊咖啡机、饮料机、自动饮水机

隔膜泵
Diaphragm Pump

型号 /Model	DP-2FM 01	DP-2FM 02	DP-2FM 03	DP-2FM 04	DP-2FM 05	DP-2FM 06
流量 / Flowrate (ml/min)	220-320	350-450	430-530	600-800	800-1000	1000-1200
最大压力 /Max Pressure(bar)	3.0±1.0	3.0±1.0	3.0±1.0	3.0±1.0	3.0±1.0	3.0±1.0
电流 /Current(mA)	≤200mA	≤200mA	≤300mA	≤500mA	≤500mA	≤500mA
偏差精度/Accuracy of deviation	±5%	±5%	±5%	±5%	±5%	±5%
噪音 /Noise(dB)	55	55	55	60	60	60
工作方式 /Duty Cycle	ED 100% or work as specified/连续工作或按指定工作方式					
电压规格 /Voltage	DC 3.7-24V					
产品认证 /Product Certificate	RoHS、REACH、FDA					

Performance Curve/ 性能曲线

测试条件: 水温20°C, 室温25°C。所有参数公差为±15%, 仅供参考。
 Test Condition: Water temperature 20°C, Indoor temperature 20°C. The tolerance range of all the parameters is ±15%. Just for reference.

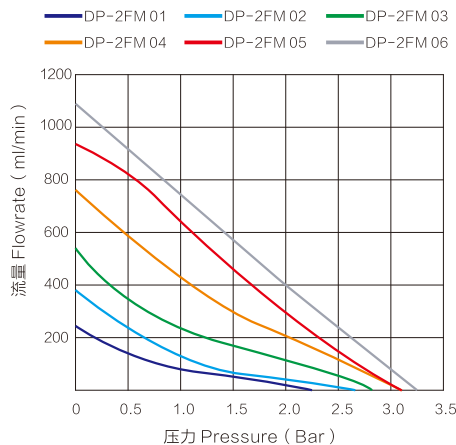

Mechanical Drawing & Dimension/ 外型尺寸

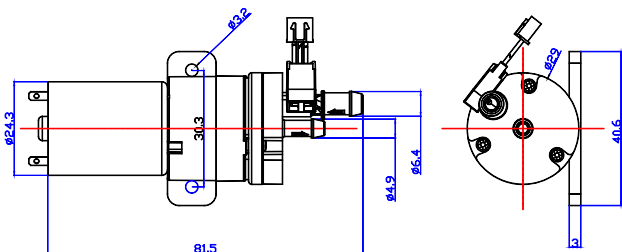

Dimensions/ 单位: millimeters/ 毫米