

外形图

标记	页数	更改文件号	更改内容	签名	年、月、日

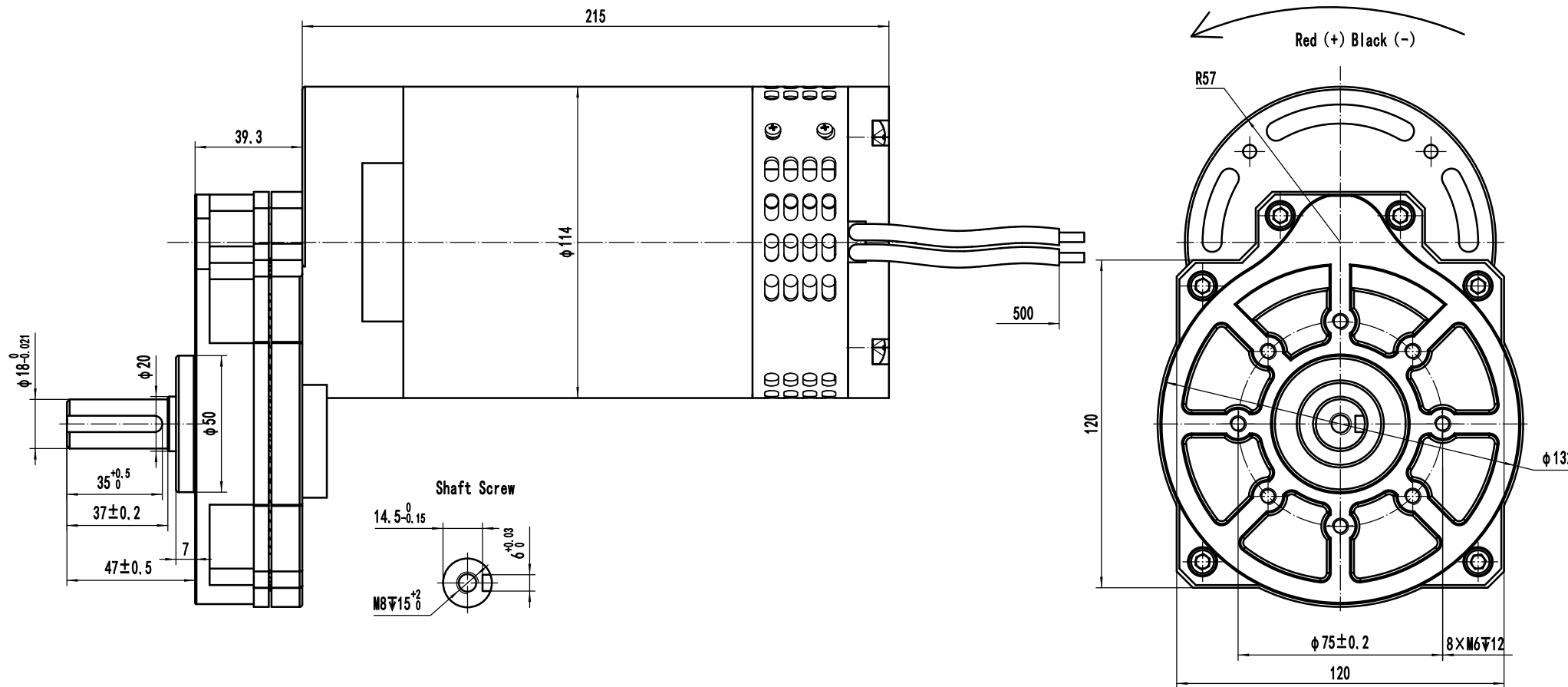

Motor Performance

Rated Voltage: DC24V

Rated Torque: 34N.m

Rated Speed: 140±10%/min

Rated Current: ≤30A

Ratio: 10.1:1

产品符合REACH指令

产品符合RoHS指令

借(通)用件登记

版本号 200317

年月日启用

未注公差	尺寸分段	0.5-3	>3-6	>6-30	>30-120	>120-400	>400-1000
线性尺寸	±0.1	±0.1	±0.2	±0.3	±0.5	±0.8	
角度尺寸	±0.2	±0.5	±1	±2	±2	±2	
尺寸分段	0.5-10	>10-50	>50-120	>120-400	>400		
极限偏差	±1°	±30'	±20'	±10'	±5'		

设计		标准化	
审核			
工艺		批准	

阶段标记	数量	比例
		1:1.5
共张	第张	

浙江联宜电机有限公司

114ZY24-500/145JC

外形图

File Message :
 File Name : 009932_2010191209_120926.DAE.idx
 Device Type : MV1000
 Serial No. : S5J606874
 Time Correction : None
 Starting Condition : Manual
 Dividing Condition : Manual
 Meas Ch. : 10
 Math Ch. : 0
 Ext Ch. : 0

Data Count : 4595
 Sampling Interval : 2.000 秒
 Start Time : 2019/12/09 11:09:26.000
 Stop Time : 2019/12/09 13:42:34.000
 Trigger Time : 2019/12/09 13:09:24.000
 Trigger No. : 3599
 Damage Check : Not Damaged
 Started by : [Key In]
 Stopped by : [Key In]

Printed Group : GROUP 1
 Printed Range : 2019/12/09 11:09:26.000 - 2019/12/09 13:42:34.000
 Comment :

	光标 A	光标 B	差
数据号码	0	4594	4594
时间	00:00:00.000	02:33:08.000	02:33:08.000
选择通道	值 A	值 B	值B-值A
CH001 [C]	18.8	54.7	35.9
CH002 [C]	18.8	58.9	40.1
CH003 [C]	17.9	55.3	37.4
CH004 [C]	17.8	58.0	40.2
CH005 [C]	14.2	17.8	3.6
CH006 [C]	20.3	37.4	17.1

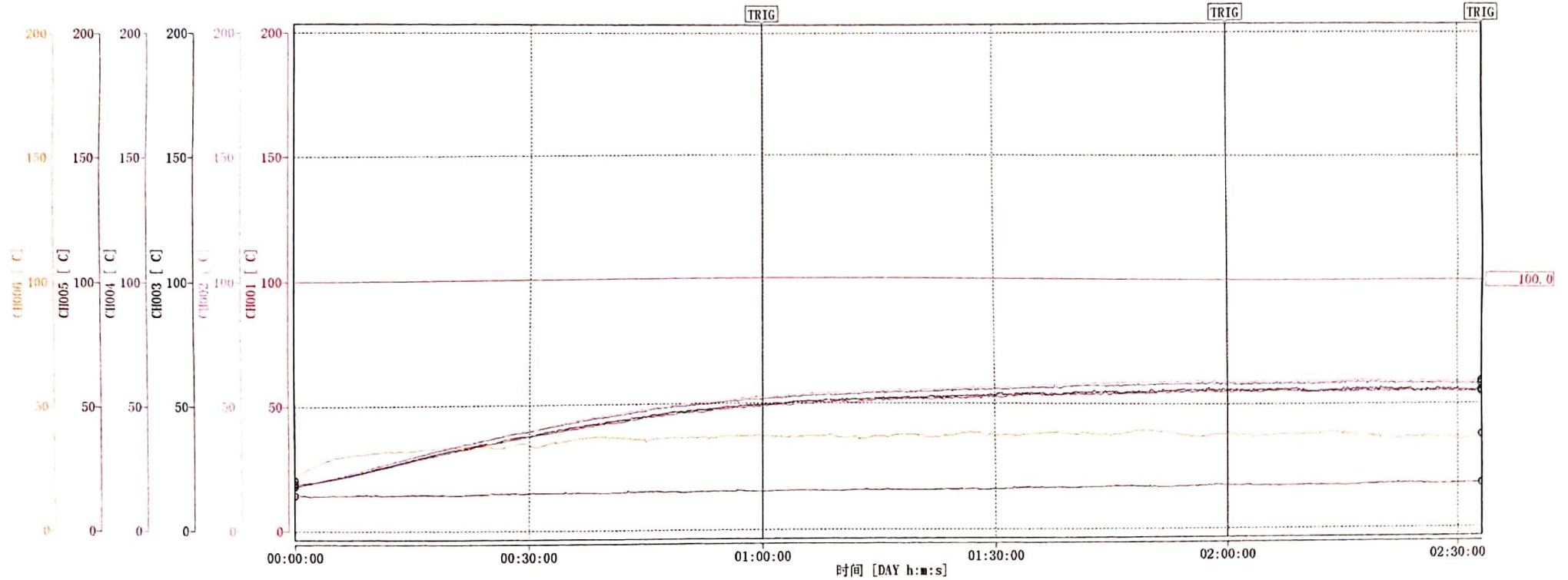

Test Report

Sample Name:DC DRIVE
 Sample Model:114ZY24-500
 Room Temp:22.6°C - 22.7°C
 Report No.:M19120109B5-2

Manufacturer:LINIX
 Other:
 Tester:磁粉测功机MPD-2000KB/W
 Test Voltage:24V

Sample No.:M19120109
 Direction:顺时针 (CW)
 Tester:QE008
 Auditor:QE018

LINIX[®] since 1968
 R/LINIX 212.1.8

创建全能王扫描

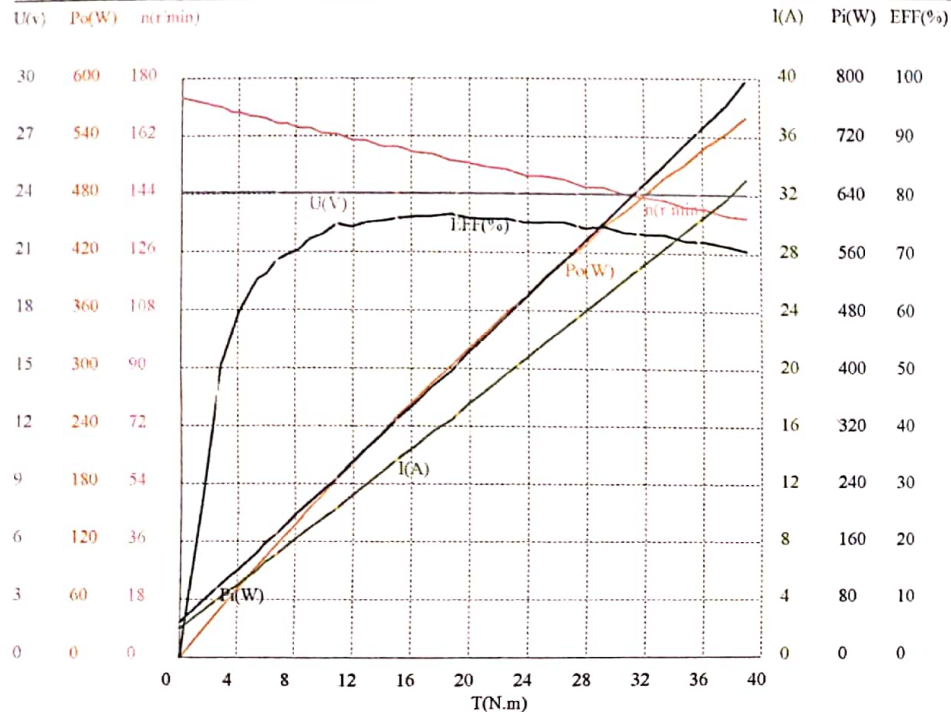

NO.	n(r/min)	T(N.m)	Po(W)	U(V)	I(A)	Pi(W)	EFF
1	174.04	0.0000	0.0000	24.055	2.0186	48.558	0.00%
2	171.03	2.8177	50.463	24.053	4.1624	100.12	50.40%
3	169.69	3.4546	61.383	24.053	4.6437	111.70	54.96%
4	169.43	4.0362	71.605	24.053	5.0187	120.72	59.32%
5	168.52	4.7077	83.073	24.052	5.5341	133.11	62.41%
6	168.24	5.3446	94.156	24.052	5.9932	144.15	65.32%
7	167.54	5.9746	104.82	24.052	6.5965	158.66	66.07%
8	166.06	6.6947	116.41	24.051	7.0636	169.88	68.52%
9	165.92	7.3800	128.22	24.050	7.6738	184.55	69.47%
10	164.66	8.1762	140.98	24.051	8.3394	200.57	70.29%
11	164.63	8.9793	154.79	24.049	8.9223	214.57	72.14%
12	163.01	9.8585	168.28	24.048	9.5811	230.41	73.04%
13	162.68	10.876	185.27	24.048	10.290	247.46	74.87%
14	160.97	11.845	199.66	24.047	11.166	268.50	74.36%
15	160.55	12.925	217.30	24.049	12.023	289.14	75.15%
16	158.93	13.957	232.27	24.048	12.817	308.22	75.36%
17	158.68	15.127	251.35	24.047	13.780	331.36	75.85%
18	157.08	16.221	266.81	24.046	14.586	350.73	76.07%
19	156.53	17.467	286.29	24.045	15.634	375.92	76.16%
20	154.57	18.706	302.76	24.044	16.451	395.56	76.54%
21	153.84	19.862	319.96	24.043	17.525	421.34	75.94%
22	152.51	21.171	338.08	24.042	18.559	446.19	75.77%
23	152.00	22.493	358.02	24.042	19.640	472.19	75.82%
24	149.82	23.857	374.27	24.040	20.722	498.15	75.13%
25	149.76	25.145	394.32	24.040	21.805	524.18	75.23%
26	148.69	26.550	413.38	24.039	22.871	549.79	75.19%
27	146.41	27.859	427.11	24.039	23.941	575.51	74.21%
28	146.29	29.264	448.26	24.038	25.036	601.81	74.49%
29	144.17	30.662	462.89	24.036	26.195	629.64	73.52%
30	143.27	32.012	480.26	24.036	27.266	655.37	73.28%
31	142.50	33.418	498.65	24.035	28.375	681.98	73.12%
32	140.51	34.782	511.76	24.033	29.517	709.37	72.14%
33	139.72	36.229	530.04	24.033	30.632	736.17	72.00%
34	137.81	37.689	543.87	24.034	31.759	763.30	71.25%
35	137.14	39.005	560.10	24.032	33.082	795.03	70.45%

Feature	n(r/min)	T(N.m)	Po(W)	U(V)	I(A)	Pi(W)	EFF
No-Load	174.04	0.0000	0.0000	24.055	2.0186	48.558	0.00%
Max-EFF	154.57	18.706	302.76	24.044	16.451	395.56	76.54%
Max-Po	137.14	39.005	560.10	24.032	33.082	795.03	70.45%
Max-T	137.14	39.005	560.10	24.032	33.082	795.03	70.45%
Locked							
Rating1	141.65	34.000	504.31	24.035	28.862	693.67	72.70%
Rating2							
Rating3							
Rating4							
Rating5							

PS. 20191209104652

Test Report

Sample Name:DC DRIVE
 Sample Model:114ZY24-500
 Room Temp:22.4℃ - 22.5℃
 Report No.:M19120109B5

Manufacturer:LINIX
 Other:
 Tester:磁粉测功机MPD-2000KB/W
 Test Voltage:24V

Sample No.:M19120109
 Direction:逆时针 (CCW)
 Tester:QE008
 Auditor:QE018

LINIX[®] since 1968
 R/LINIX 212.1.8

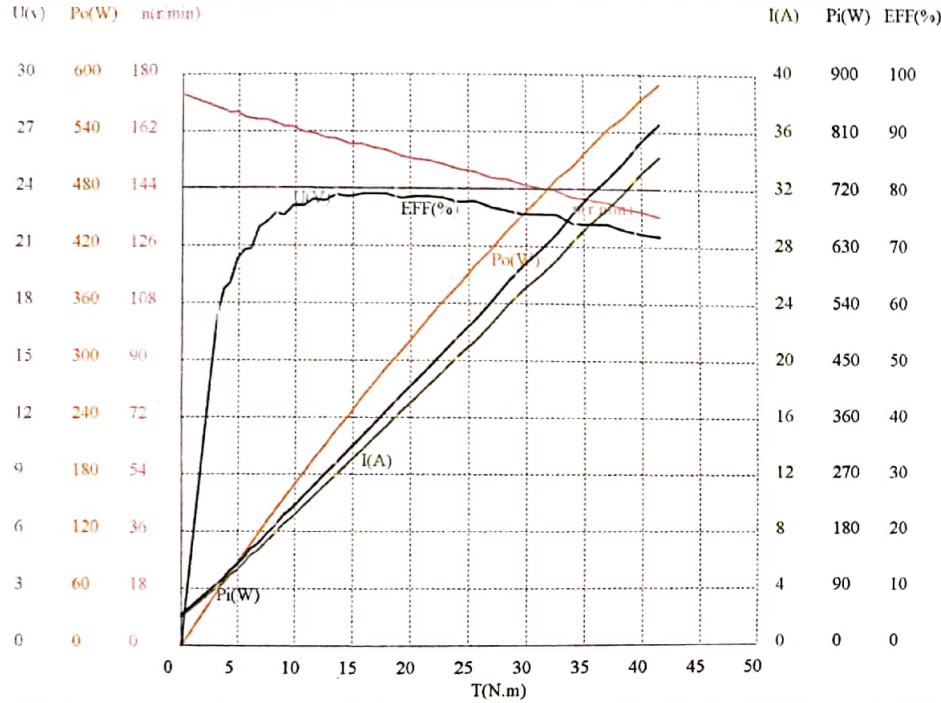

NO.	n(r/min)	T(N.m)	Po(W)	U(V)	I(A)	Pi(W)	EFF
1	173.86	0.0000	0.0000	24.036	2.0221	48.604	0.00%
2	169.61	3.1436	55.831	24.034	4.0273	96.790	57.68%
3	168.79	3.6943	65.294	24.032	4.3539	104.63	62.40%
4	167.96	4.2379	74.536	24.030	4.8819	117.31	63.54%
5	168.29	4.8583	85.611	24.030	5.2626	126.46	67.70%
6	166.74	5.4926	95.897	24.029	5.7672	138.58	69.20%
7	166.30	6.0572	105.48	24.029	6.3125	151.68	69.54%
8	165.73	6.7821	117.70	24.030	6.6893	160.74	73.22%
9	165.74	7.5070	130.29	24.029	7.3049	175.53	74.23%
10	164.88	8.2737	142.84	24.029	7.8516	188.66	75.71%
11	163.68	8.9917	154.11	24.027	8.5229	204.78	75.26%
12	163.46	9.7793	167.39	24.027	9.0512	217.47	76.97%
13	161.92	10.706	181.52	24.025	9.8052	235.57	77.06%
14	161.64	11.578	195.96	24.024	10.435	250.68	78.17%
15	160.12	12.588	211.07	24.022	11.275	270.84	77.93%
16	159.86	13.536	226.58	24.023	11.939	286.82	79.00%
17	158.28	14.631	242.48	24.021	12.849	308.65	78.56%
18	158.11	15.753	260.80	24.021	13.734	329.90	79.05%
19	156.99	16.805	276.26	24.020	14.540	349.26	79.10%
20	156.08	17.955	293.46	24.018	15.451	371.10	79.08%
21	154.27	19.168	309.64	24.018	16.450	395.09	78.37%
22	153.52	20.235	325.29	24.017	17.237	413.96	78.58%
23	153.01	21.489	344.29	24.017	18.215	437.47	78.70%
24	151.92	22.786	362.48	24.017	19.234	461.95	78.47%
25	150.28	24.096	379.18	24.016	20.328	488.18	77.67%
26	149.61	25.567	400.52	24.015	21.420	514.39	77.86%
27	147.58	26.975	416.86	24.014	22.592	542.53	76.84%
28	147.10	28.397	437.41	24.013	23.913	574.23	76.17%
29	145.47	29.805	454.00	24.012	25.013	600.61	75.59%
30	144.37	31.178	471.32	24.012	25.948	623.05	75.65%
31	143.66	32.621	490.70	24.012	27.050	649.53	75.55%
32	141.49	34.015	503.97	24.010	28.345	680.56	74.05%
33	140.89	35.472	523.31	24.010	29.519	708.76	73.84%
34	139.95	37.089	543.53	24.009	30.662	736.16	73.83%
35	137.95	38.525	556.49	24.008	31.791	763.23	72.91%
36	137.21	39.947	573.92	24.006	33.087	794.28	72.26%
37	135.57	41.578	590.22	24.006	34.248	822.17	71.79%

Feature	n(r/min)	T(N.m)	Po(W)	U(V)	I(A)	Pi(W)	EFF
No-Load	173.86	0.0000	0.0000	24.036	2.0221	48.604	0.00%
Max-EFF	156.99	16.805	276.26	24.020	14.540	349.26	79.10%
Max-Po	135.57	41.578	590.22	24.006	34.248	822.17	71.79%
Max-T	135.57	41.578	590.22	24.006	34.248	822.17	71.79%
Locked							
Rating1	141.52	34.000	503.83	24.010	28.331	680.22	74.07%
Rating2							
Rating3							
Rating4							
Rating5							

PS. 20191209104459

扫描全能王 创建

