

电源接插件
Link Plug-in unit

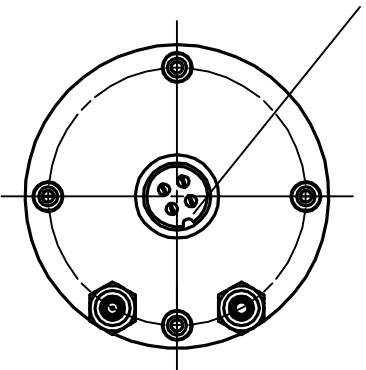

ER11

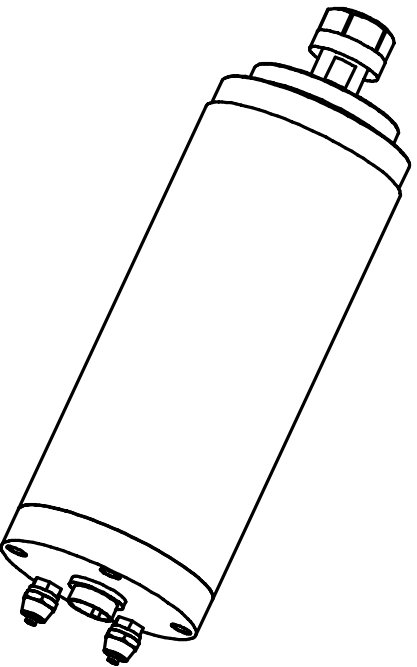
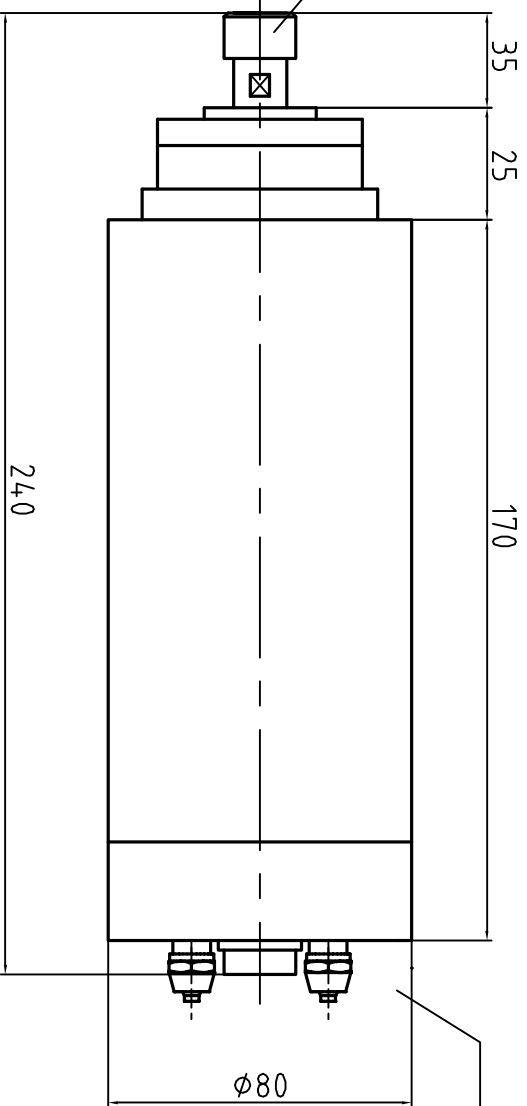

常州精控电机电器有限公司 Changzhou Jingkong Motor&Electric Appliance Co.,Ltd			
型号 Model	Φ80 1.5KW 圆形 水冷 Φ80 1.5KW water-cooling circular spindle		
名称 Name	雕铣机电主轴 Spindle		
轴承润滑 Bearing Lubrication	油脂润滑 Grease		
刀柄规格 Specification	ER11	额定电压 Rated Voltage	220V
额定功率 Rated Power	1.5KW	轴承型号 Bearing	C7002X2
电流 Electric current	8A	额定转速 Rated Speed	1Kr/min
频率 Frequency	400HZ	最高转速 Highest rotational Speed	2.4Kr/min